

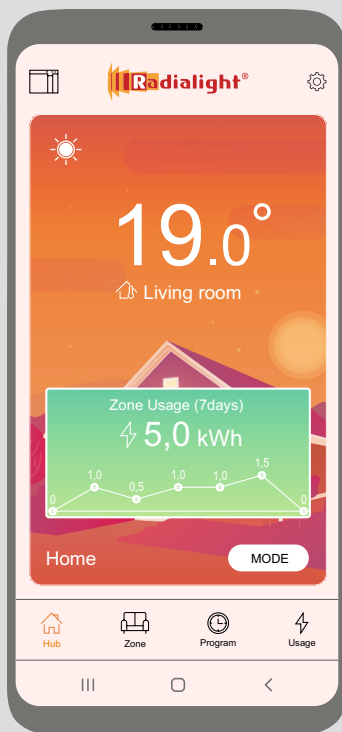

Wi-Fi APP



Quick Start Guide

android

(version 7.0 or later)

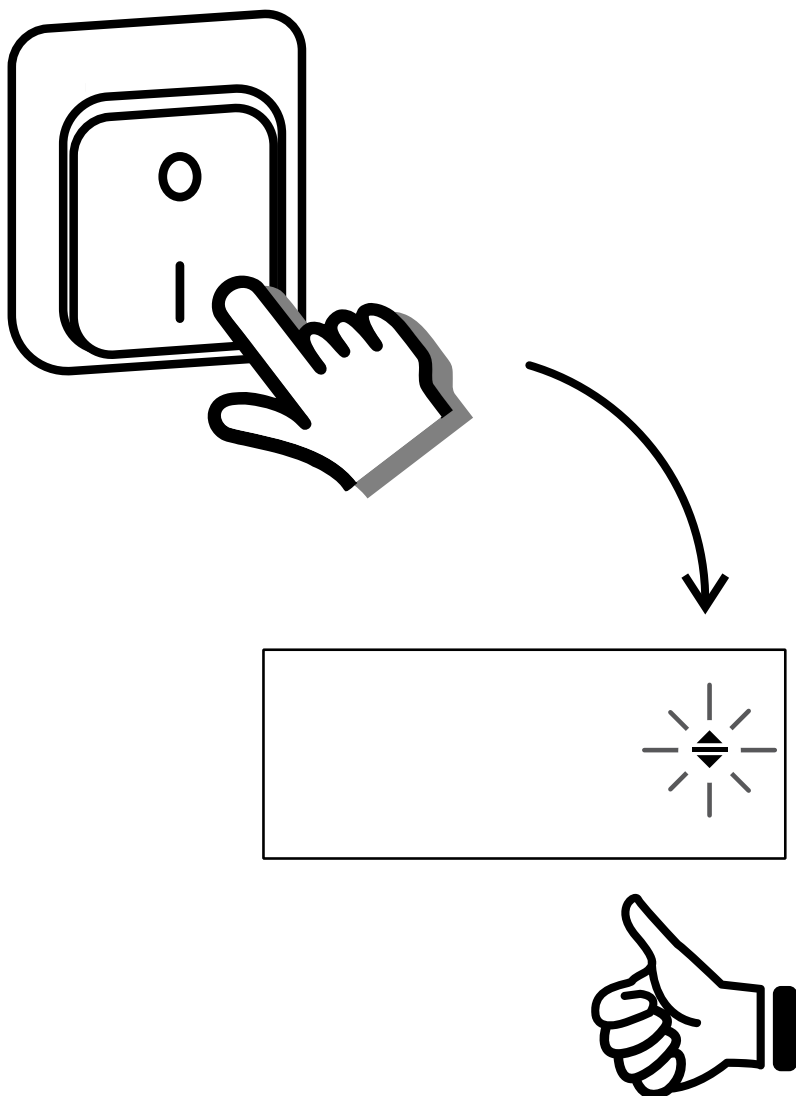

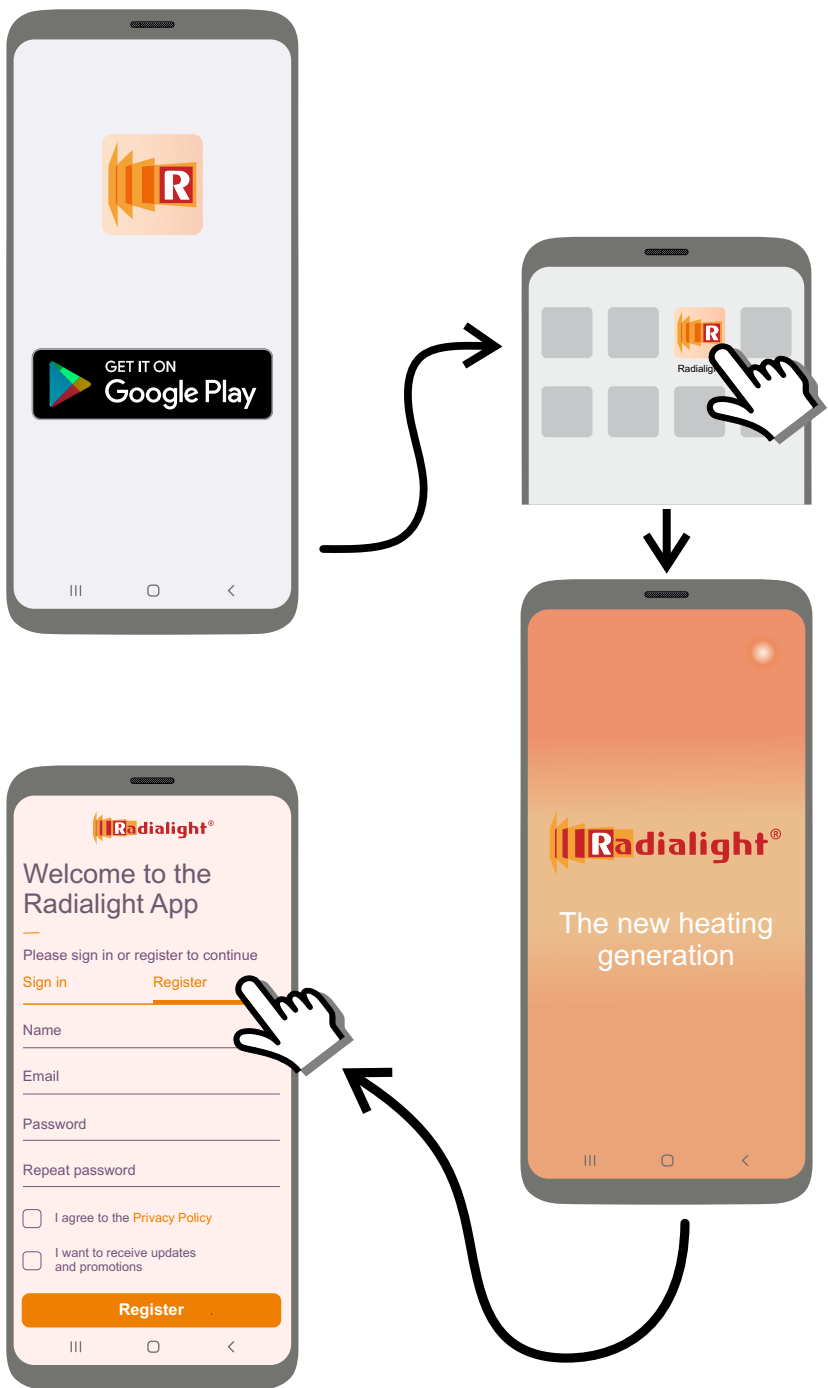

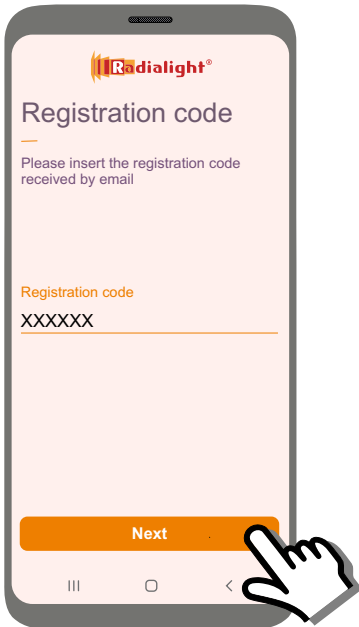
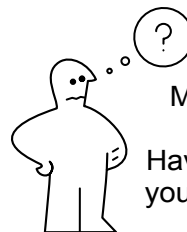
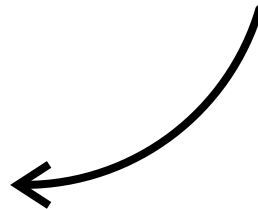
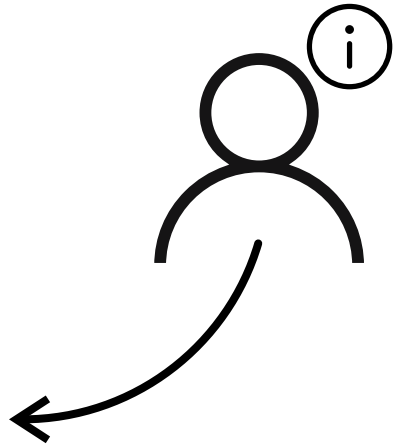
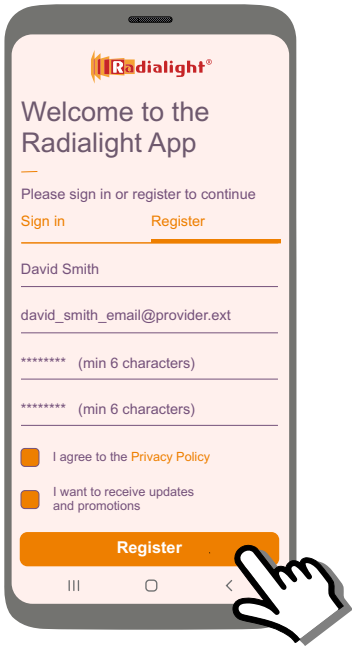

Missing email?

Have you checked your SPAM folder?

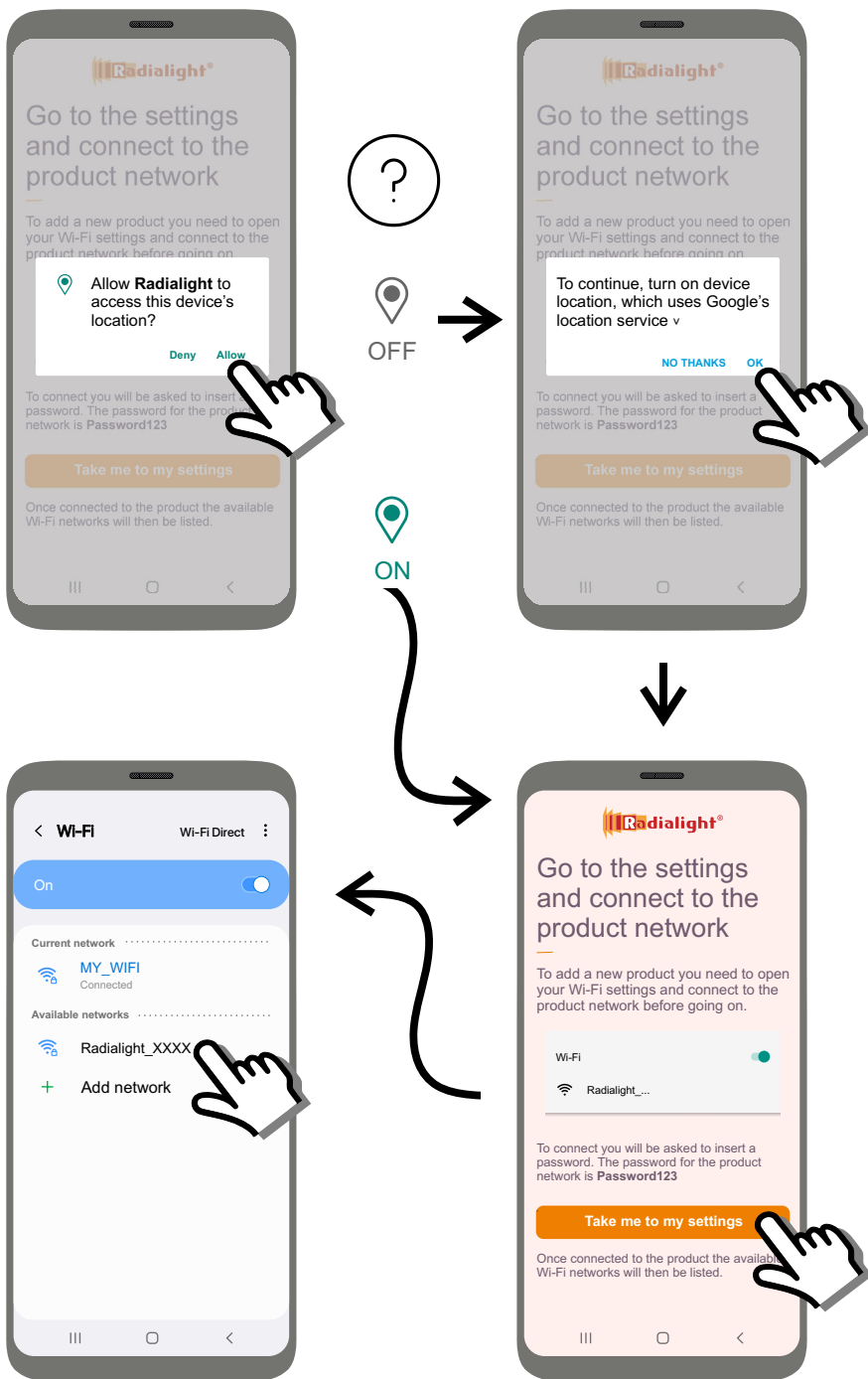

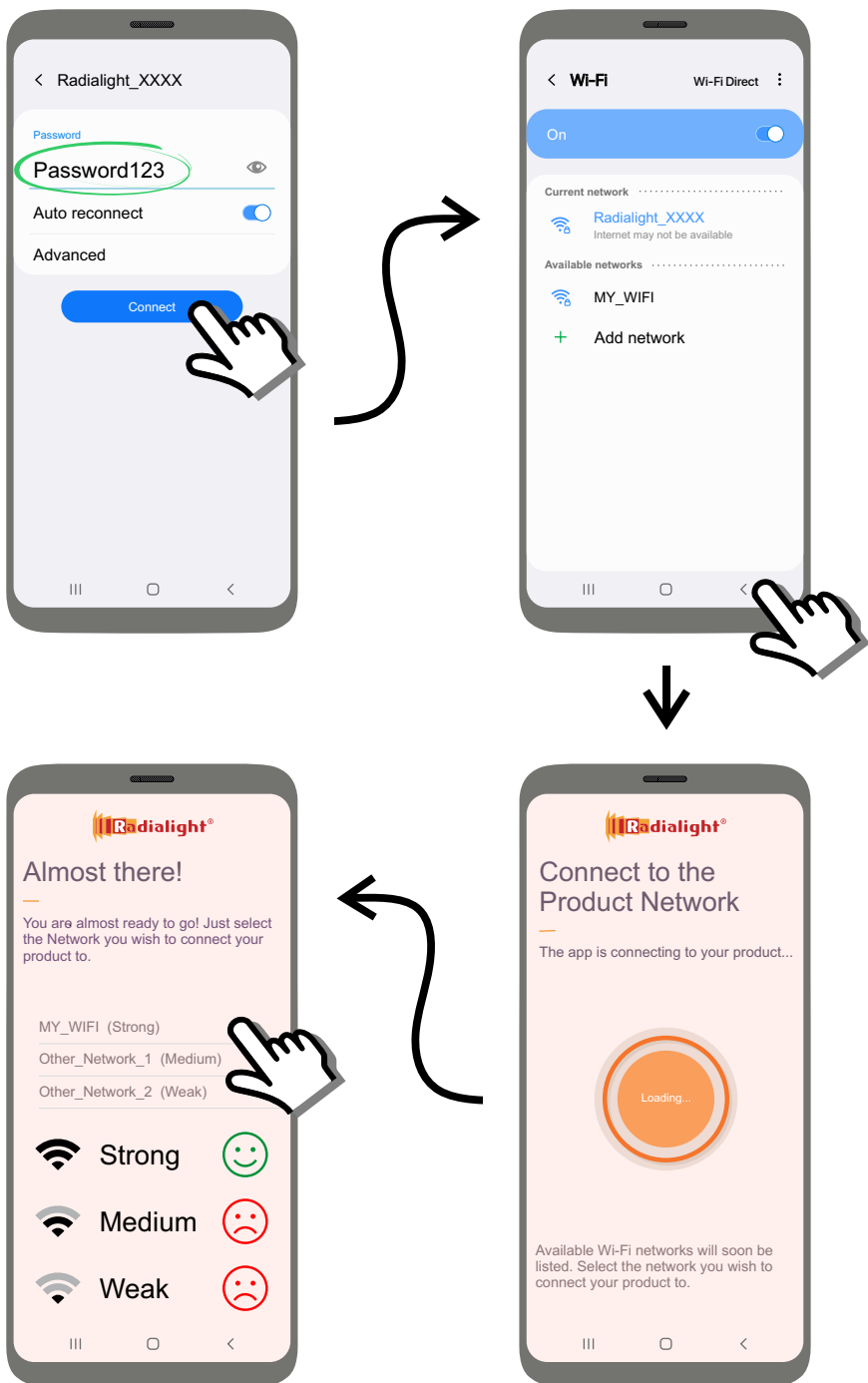

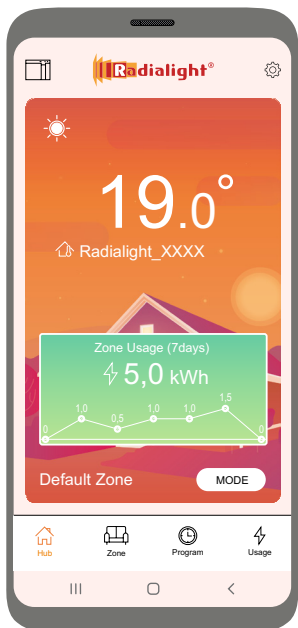
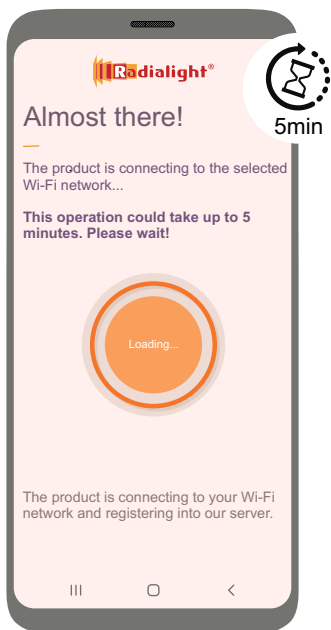
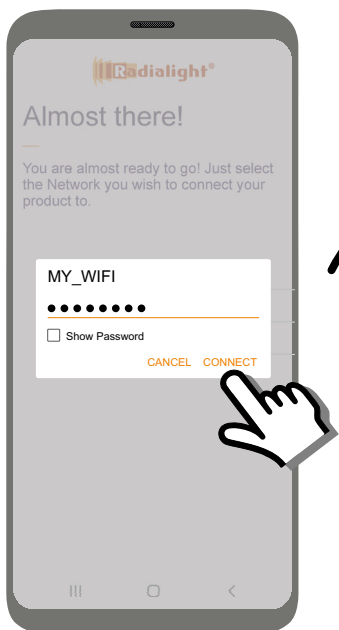

UNABLE TO REGISTER YOUR PRODUCT? Try this:

1 - Reset the heater

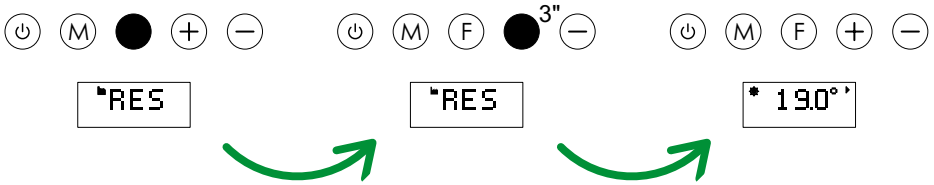

2 - Set the Wi-Fi to Access Point mode

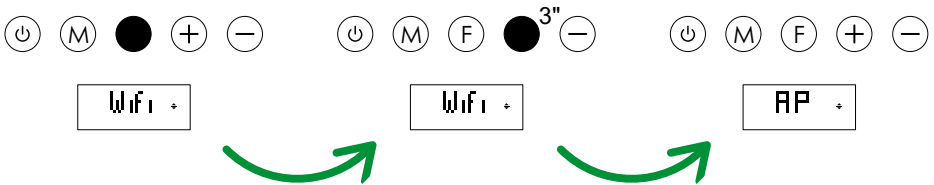

3 - Switch OFF the heater



4 - Close the App

5 - Open the App

6 - Switch ON the heater and wait 30"

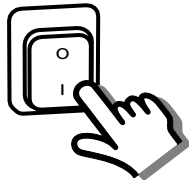

7 - Try again to add the product



www.radialight.com/app-support

ISAPP001_R1